

FIXTURE SCHEDULE					
SYM.	DESCRIPTION	HOT	COLD	WASTE	VENT
(DF-1)	BI-LEVEL DRINKING FOUNTAIN - ELKAY MODEL EZ-STL8MSLK WITH E2H2O BOTTLE FILLER FLEXI-GUARD BUBBLERS, 1/2" STOP AND 1-1/2" P-TRAP. PROVIDE ALL INTERCONNECTING PIPING AND DRAIN.	---	1/2"	1-1/2"	1-1/2"
(FD-1)	2" FLOOR DRAIN WITH PRIMER - ZURN Z-415B WITH 5"Ø NICKEL-BRONZE STRAINER AND 2" DEEP SEAL P-TRAP WITH ZURN I022 TRAP PRIMER.	---	1/2" FEX	2"	2"
(FD-2)	2" FLOOR DRAIN - ZURN Z-415B WITH 5"Ø NICKEL-BRONZE STRAINER AND 2" DEEP SEAL P-TRAP.	---	---	2"	2"
(JS-1)	FLOOR MOUNTED SERVICE SINK - KOHLER K-6710 "WHITBY" W/ K-8440 WIRE RIM GUARD, K-8428 FAUCET ASSEMBLY AND K-9142 STRAINER WITH DEEP SEAL P-TRAP.	1/2"	1/2"	2"	2"
(L-1)	ADA WALL MOUNTED LAVATORY - KOHLER 2023 "GREENWICH" (SIZE 20"x18") WITH K-T115 OPEN GRID STRAINER, MOEN L4601 FAUCET. 1/2" STOPS AND 1-1/2" P-TRAP. PROVIDE INSULATING JACKET ON WATER AND WASTE PIPE. PROVIDE CONCEALED ARM CARRIER SYSTEM.	1/2"	1/2"	1-1/2"	1-1/2"
(L-2)	ADA COUNTERTOP LAVATORY - KOHLER MODEL K-2405-4 SELF-RIMMING "FARMINGTON" WITH MOEN L4601 LEVER FAUCET, K-T115 OPEN GRID STRAINER, 1/2" BALL STOPS AND 1-1/4" P-TRAP. INSULATE HOT WATER SUPPLY AND TRAP WITH JACKET.	1/2"	1/2"	1-1/2"	1-1/2"
(RP-1)	CIRCULATING PUMP - GRUNDFOS MODEL UP15-10B7 BRONZE PUMP WITH 3/4" FLANGES (2 GPM @ 5' OF HEAD) 120/60/1	3/4" HNRG	---	---	---
(SD-1)	2" SHOWER DRAIN - ZURN Z-415B WITH 5"Ø NICKEL-BRONZE STRAINER AND 2" DEEP SEAL P-TRAP	---	---	2"	2"
(SH-1)	ADA SHOWER - AQUATIC MODEL 1363BF5 36"x36"x13-1/4" SHOWER WITH FOLD UP SEAT, GRAB BARS, SHOWER CURTAIN & ROD, HANDHELD SHOWER ASSEMBLY WITH 24" SLIDE BAR, T&P BALANCING VALVE. SEE PLAN FOR RIGHT OR LEFT HAND.	1/2"	1/2"	2"	2"
(SH-2)	SHOWER - AQUATIC MODEL 1363BF5 36"x36"x13-1/4" SHOWER WITH GRAB BARS, SHOWER CURTAIN & ROD, FIXED HEAD SHOWER ASSEMBLY, T&P BALANCING VALVE. SEE PLAN FOR RIGHT OR LEFT HAND.	1/2"	1/2"	2"	2"
(SH-3)	PACKAGED WALL SHOWER - ACORN MODEL 480B-W SINGLE WALL SHOWER WITH T&P MIXING VALVE AND SHOWER HEAD	1/2"	1/2"	---	---
(U-1)	ADA WALL MOUNTED URINAL - KOHLER K-4484-T "FRESHMAN" WITH WALL CARRIER & SLOAN REGAL BATTERY FLUSH VALVE. MOUNT AT ADA LEVEL.	---	3/4"	2"	2"
(U-2)	WALL MOUNTED URINAL - KOHLER K-4484-T "FRESHMAN" W/ WALL CARRIER & SLOAN REGAL BATTERY FLUSH VALVE.	---	3/4"	2"	2"
(WB-1)	WASHING MACHINE HOOK-UP - GUY GRAY MODEL BB200T5 COMBINATION BOX COMPLETE WITH 2" WASTE LINE AND P-TRAP, 1/2" HOT & COLD WATER LINES FROM TOP	---	---	2"	2"
(WC-1)	ADA FLUSH VALVE WATER CLOSET - KOHLER K-4368 "HIGHCLIFF" WITH ELONGATED BOWL, K-4610C WHITE OPEN FRONT SEAT, SLOAN REGAL BATTERY FLUSH VALVE AND CHINA BOLT CAPS.	---	1"	4"	2"
(WC-2)	FLUSH VALVE WATER CLOSET - KOHLER K-4350 "MELCOMME" WITH ELONGATED BOWL, K-4610C WHITE OPEN FRONT SEAT, SLOAN REGAL BATTERY FLUSH VALVE AND CHINA BOLT CAPS.	---	1"	4"	2"
(WH-1)	75 GALLON GAS WATER HEATER - A.O. SMITH MODEL GPD75L POWER DIRECT VENT GAS WATER HEATER WITH 120 VOLT POWER CORD, AMTROL ST-5 EXPANSION TANK, T&P VALVE, 70,000 BTU INPUT	3/4"	3/4"	---	---

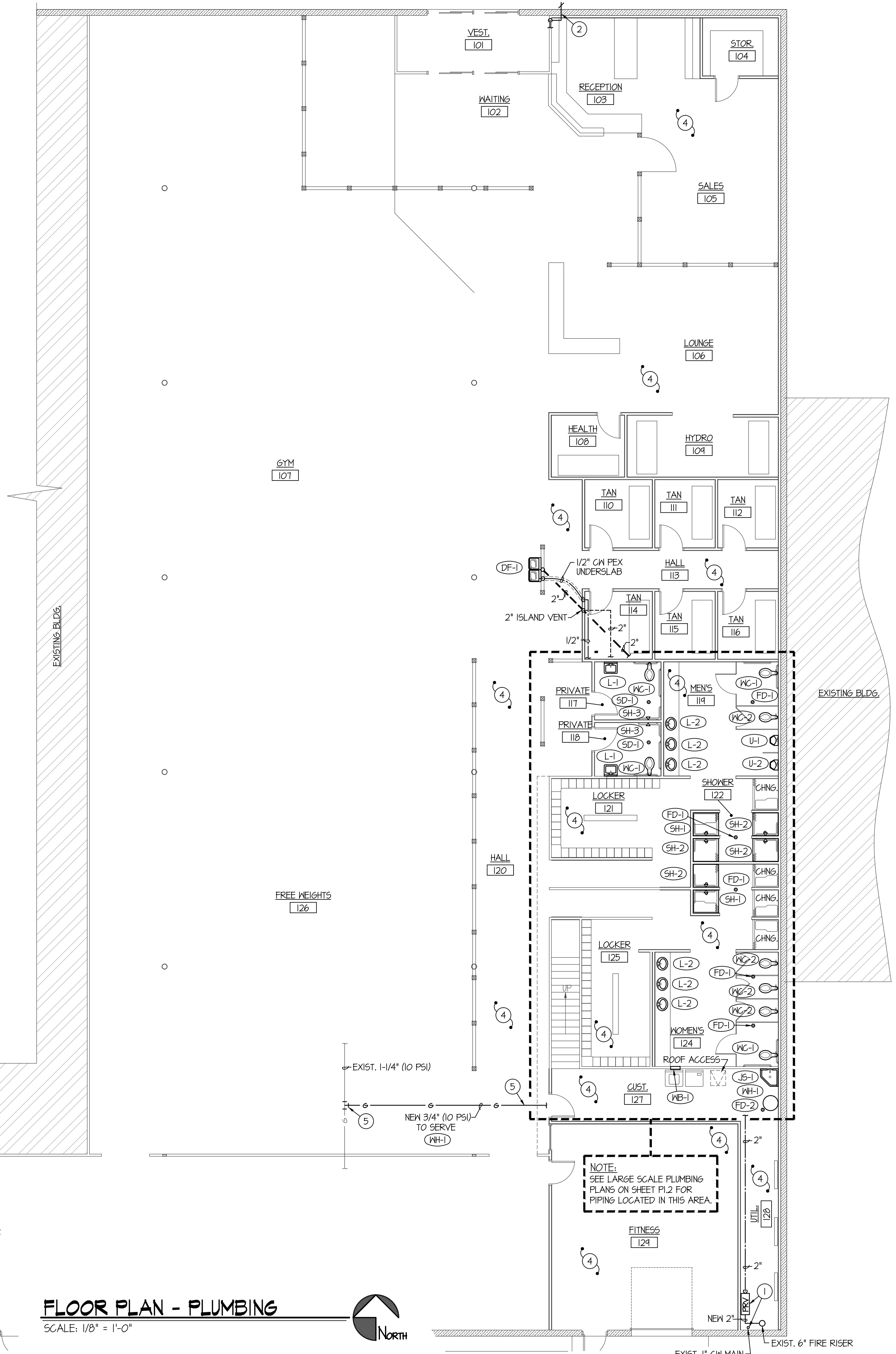

PLAN NOTES:

- CAP EXISTING 1" CN MAIN BACK NEAR FLOOR. REMOVE EXISTING WATER METER. TIE INTO EXISTING FIRE SPRINKLER MAIN LINE NEAR FLOOR PRIOR TO ANY VALVES WITH NEW 2" CN MAIN COMPLETE WITH PRESSURE REDUCING VALVE ASSEMBLY AND 2" WATER METER. SEE DETAIL ON SHEET P200.
- EXISTING HOSE BIBB AND SHUT-OFF VALVE TO REMAIN. PROTECT DURING CONSTRUCTION.
- EXISTING GAS METER TO REMAIN. PROTECT DURING CONSTRUCTION.
- MODIFY EXISTING FIRE SPRINKLER PIPING AND HEADS IN REMODELED AREAS AS PER NFPA 13 REQUIREMENTS.
- CONNECT NEW 3/4" (10 PSI) GAS LINE TO EXISTING 1-1/4" (10 PSI) LINE ON ROOF AND RUN ACROSS ROOF TO SERVE NEW WATER HEATER WH-1 BELOW. SUPPORT GAS PIPING ON ROOF USING ERICO PIPE PIER SUPPORTS (OR EQUAL) AT 10'-0" ON CENTER.

PLUMBING LEGEND

SYMBOL	DESCRIPTION
V	VENT
VTR	VENT THRU ROOF
CO	CLEANOUT
NCO	NALL CLEANOUT
COTG	CLEANOUT TO GRADE
—	PIPE DROP
—	PIPE RISE
⊘	BALL TYPE ISOLATION VALVE
---	SOIL OR WASTE PIPING
---	VENT LINE PIPING
---	DOMESTIC COLD WATER PIPING
---	DOMESTIC HOT WATER PIPING
---	HOT WATER RECIRC. PIPING
—	GAS PIPING
—	CONDENSATE DRAIN PIPING

GENERAL NOTES:

- A- THE CONTRACTOR SHALL CHECK AND VERIFY ALL DIMENSIONS AND CONNECTIONS ON THE JOB SITE. ALL WORK SHALL BE EXECUTED FROM MEASUREMENTS TAKEN AT THE SITE.
- B- THE MECHANICAL CONTRACTOR SHALL BE RESPONSIBLE TO INSURE PROPER CODE CLEARANCES FOR ELECTRICAL AND MECHANICAL ACCESS WHEN INSTALLING ANY EQUIPMENT SUPPLIED BY THE MECHANICAL CONTRACTOR.
- C- IT IS CRITICAL THAT THIS CONTRACTOR COORDINATE EQUIPMENT LOCATIONS WITH PIPING, DUCTWORK, ELECTRICAL CONDUIT AND BUILDING STRUCTURE TO INSURE CODE COMPLIANCE.
- D- CEILING DIFFUSERS ARE SHOWN IN APPROXIMATE LOCATIONS. REFER TO LIGHTING PLANS AND REFLECTED CEILING PLAN FOR EXACT LOCATIONS.
- E- DUCT DIMENSIONS CALLED OUT ON DRAWINGS ARE INSIDE FREE AREA DIMENSIONS. ACOUSTICAL DUCT LINER ARE TO BE ADDED TO OVERALL MEASUREMENTS.
- F- ALL DUCTWORK AND PIPING WHICH PASSES THRU FIRE RATED WALLS TO BE FIRE STOPPED WITH APPROVED FOAM OR SEALANT. REFER TO SPECIFICATIONS FOR APPROVED MANUFACTURERS.

ORIGINAL DRAWING SIGNED BY: DWAYNE G. SUDMEERS
 DATE ORIGINAL SIGNED: Oct 03, 2018
 ORIGINAL ON FILE AT ENGINEERED SYSTEMS ASSOCIATES
 1355 EAST CENTER, POCATELLO, IDAHO 83201

Engineered Systems Associates
 1355 EAST CENTER
 POCATELLO, IDAHO 83201
 PHONE: (208) 233-0501
 FAX: (208) 233-0529
 EMAIL: esa@engsystems.com
 ESA JOB NUMBER: 18061

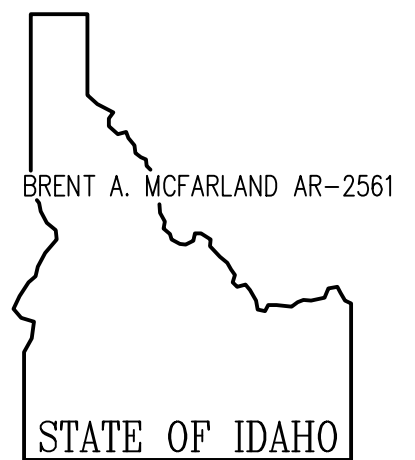

JRW & ASSOCIATES
 BRENT A. MCFARLAND AR-2561
 1152 BOND AVENUE - Suite A - REBURG, IDAHO 83440
 WWW.JRW.COM VOICE (208) 359-2309 FAX (208) 359-2271

CONSULTANTS:
 MECHANICAL ENGINEERING
 ENGINEERED SYSTEMS ASSOC.
 1355 East Center
 Pocatello, Idaho 83201
 (208) 233-0501
 Fax (801) 233-0529
 ELECTRICAL ENGINEERING
 PAYNE ENGINEERING INC.
 1823 E. Center St.
 Pocatello, Idaho 83201
 (208) 232-4439
 Fax (208) 232-1435

PROJECT: WORLD GYM REMODEL
 IDAHO FALLS, IDAHO
 DRAWING TITLE: PLUMBING FLOOR PLAN

REVISION:		
#	DATE	COMMENT

DRAWN BY: SR JOB NO: 756
 CHECKED BY: DCS DATE: OCT, '18
 PLOT DATE: 09-26-18
 DRAWING NO. FILE: 18061 P1.1.dwg
 P.1
 OF -

FLOOR PLAN - PLUMBING
 SCALE: 1/8" = 1'-0"